

# LEONARD PETERSON & CO., INC.

---

## PETERSON VANGUARD LINE Construction Features...

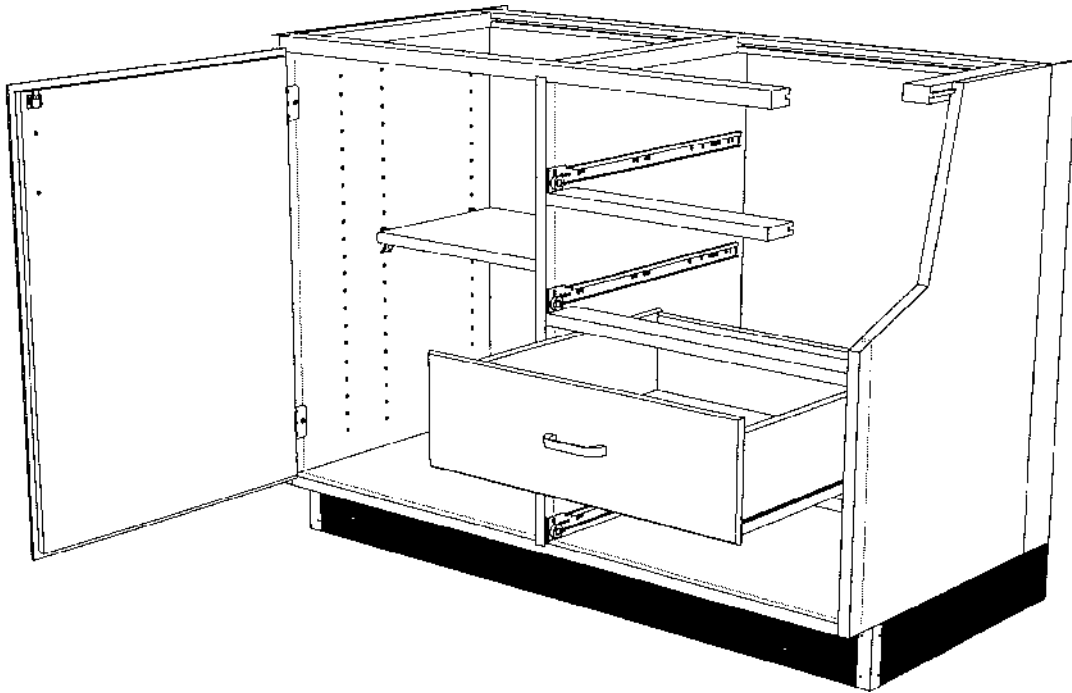

1. Cabinets constructed with exposed parts made of solid select red oak in combination with select plain sliced red oak veneers.
2. Frame construction having solid hardwood top frames and solid oak faced hardwood plywood bottoms. Intermediate rails made of one-piece solid oak. Cabinet frames, rails and bottoms are blind mortise and tenoned into cabinet walls and/or partitions, providing the strongest construction available in the industry.
3. Cabinet walls and partitions provided with solid oak facers, thus cabinet hinges, lock cutouts and catches attach to solid oak for maximum strength and durability.
4. Cabinet interiors are flush, with no offsets, for ease of cleaning and maximum drawer and cupboard space.
5. Drawers made with solid oak drawer fronts and unidirectional hardwood drawer sides and backs. 1/4" thick tempered hardboard drawer bottoms are fully grooved into drawer fronts, sides and backs. All joints are glued.
6. Drawers are provided with 100 pound (dynamic load) three-quarter extension roller bearing slides having positive stops. Slides are epoxy coated for chemical resistance. Optional 150 pound full extension slides available when specified.
7. Cabinet doors are 5-ply solid core with nominal 1-3/4" solid hardwood bandings. Door faces provided with book matched plain sliced red oak veneers. All paired doors have matched grain pattern.
8. Doors are secured to cabinets with institutional 5-knuckle stainless steel hinges and have adjustable nylon roller catches to ensure easy, quiet and positive door closing. Doors and drawers are provided with exposed aluminum pulls resistant to chemical attack. Pulls are unconditionally guaranteed against breakage or stripping of the fastening threads.
9. Hardwood plywood shelves faced with solid oak and adjustable on 1-1/4" centers. All Tall Storage Cases provided with 1" thick shelves. Shelves supported on corrosion resistant nylon clips. Clips are provided with integrally molded anti-tipping restraint and 2 stems which engage cabinet wall for proper alignment. Each clip is capable of supporting 400 pounds.
10. Knee space rails, table aprons, and table legs are made of solid oak lumber.
11. Cabinet exteriors receive hand stain as selected, and all cabinet exteriors, cupboard interiors and drawer interiors receive triple pass coat of conversion sealer and varnish for optimum chemical resistance.
12. Exposed cabinet edges and corners are rounded 3/16" to prevent fraying, splintering, and denting.
13. Vanguard cabinets are covered by a two (2) year manufacturer's warranty.

These features by Leonard Peterson & Co., Inc., are no longer provided as standard by other manufacturers.

---

PETERSON IS QUALITY